

AIRCAST®

Product Catalogue



AIRCAST®

For more than 30 years, medical professionals worldwide have depended on Aircast® for technological breakthroughs in patient care.

Rooted in sound scientific methods, each Aircast product is developed using the concept of "functional management." We have set a new standard of care for lower limb fractures, ankle sprains and other injuries with our patented technology and use of graduated pneumatic compression.

Aircast is a brand of DJO Global. DJO is a leading global developer, manufacturer and distributor of high-quality medical devices whose brands are dedicated to providing the continuum of patient care from injury prevention to rehabilitation after surgery, injury or degenerative disease.

AirSelect™ Elite



Cryo/Cuff™ Cooler



Air-Stirrup II™



Pneumatic Armband



Contents Page

Ankle & Foot Braces	2
Air-Stirrup II™	3
Air-Stirrup® "Classic"	4
Air-Stirrup® Universe™	4
Air-Stirrup Light™	4
A60™ Ankle Support	5
AirSport™	5
Jump Brace™	6
Infrapatellar Band	6
AirHeel™	7
Dorsal Night Splint	7
AirLift™ PTTD Brace	7

Walkers	8
AirSelect™ Range	9
AirSelect™ Elite	10
AirSelect™ Standard	11
AirSelect™ Short	11
Weather Cover	12
Hygiene Cover	12
Toe Cover	12
Heel Wedges	12
Brace Lok	12
XP Diabetic Walker™	13

Upper Extremity	14
A2™ Wrist Brace	15
StabilAir™ Wrist Brace	15
Quick-Fit Shoulder Immobiliser	16
Arm Immobiliser	16
Mayo Clinic Elbow Brace	17
Pneumatic Armband	17

Cold Therapy	18
Cryo/Cuff™ IC Cooler	19
Cryo/Cuff™ Cooler	19
AutoChill® System	19
Cryo/Cuff™ Wraps & Cuffs	20
- Knee Cuff SC	20
- Ankle Cuff	20
- Calf Cuff	20
- Knee Cuff	20
- Thigh Cuff	20
- Hand/Wrist Cuff	20
- Back/Hip/Rib Cuff	20
- Elbow Cuff	20
- Shoulder Cuff	20
- Pediatric Knee/Elbow Cuff	20
- Pediatric Ankle Cuff	20

Ankle & Foot Braces



Air-Stirrup II™

Indications

- Acute injury
- Post-op
- Ankle Sprains (grade I, II, & III)

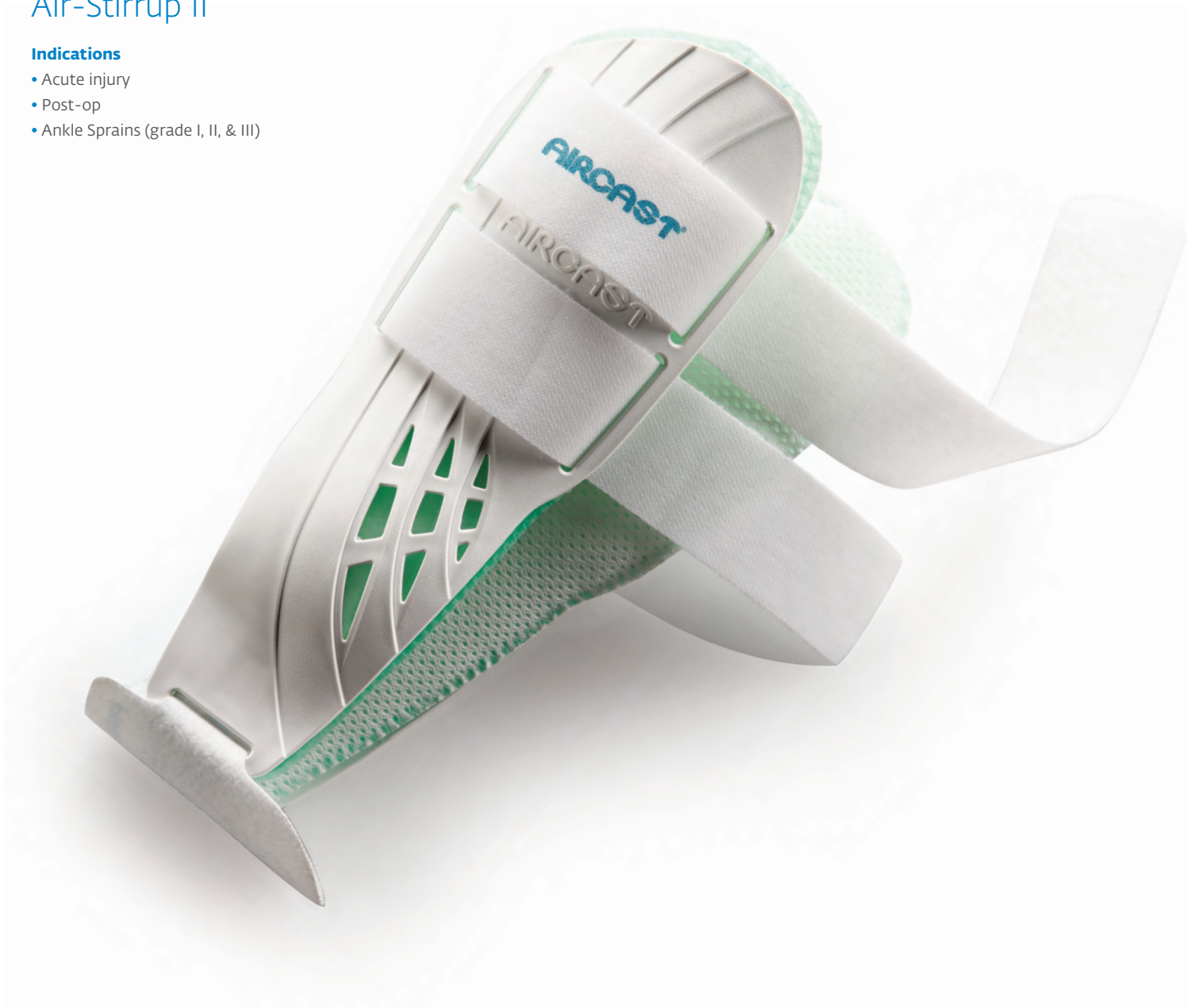

Features and Benefits

- Duplex™ Aircell System (pre-inflated distal aircell and overlapping proximal aircell) enhances circulation, reduces the swelling by milking away the edema, accelerates the healing process and helps an early return to function
- Stylized medial and lateral anatomical semi-rigid shells provide support and protection and help prevent inversion/eversion or re-injury
- Rear step-in design & strapping configuration facilitates application of the brace
- Breathable soft mesh liner for increased comfort
- Foot icon assures correct Left/Right orientation

Ordering Information

Air-Stirrup II				
Part Number		Size	Patient Height	Brace Length
Left	Right			
02VSL	02VSR	Small	< 1.57 m (< 5'2")	21.6 cm (8.5")
02VML	02VMR	Medium	1.57-1.67 m (5'2"-5'6")	23.5 cm (9.25")
02VLL	02VLR	Large	> 1.62 m (> 5'4")	26.7 cm (10.5")



Air-Stirrup® “Classic”



Indications

- Acute ankle distortion grade I, II & III
- Post-operative application
- Chronic ankle instability

Features and Benefits

- Semi-rigid, anatomically designed shells for protection, comfort and the prevention of inversion/eversion
- Patented Duplex aircell system to enhance circulation and reduce swelling
- Pre-inflated aircells for easy application
- Streamlined to fit in shoes for early protected weight-bearing

Ordering Information

Air-Stirrup “Classic”				
Part Number		Size	Patient Height	Brace Length
Left	Right			
02CL	02CR	Small	< 1.57 m (< 5'2")	22 cm (8.7")
02BL	02BR	Training (Medium)	1.57-1.67 m (5'2"-5'6")	23 cm (9.0")
02AL	02AR	Standard (Large)	> 1.62 m (> 5'4")	27 cm (10.5")
02JL	02JR	Pediatric	Small children	15 cm (6.0")

Air-Stirrup® Universe™



Indications

- Ankle sprains
- Chronic ankle instability

Features and Benefits

- Patented Duplex aircell system to reduce swelling and pain by enhanced circulation
- Universal semi-rigid shell design fits left and right ankle
- Universal size

Ordering Information

Air-Stirrup Universe	
Part Number	Size
02E	Universal

Air-Stirrup Light™



Indications

- Ankle sprains
- Chronic instability

Features and Benefits

- Foam padded ankle brace with distal aircell for additional comfort
- Fits left or right ankle
- Universal size

Ordering Information

Air-Stirrup Light		
Part Number	Brace Length	Size
02F	24 cm (9½")	Universal



A60™ Ankle Support

Indications

- Prophylaxis
- Chronic instability

Features and Benefits

- A 60° stabiliser guards against rollover and helps prevent sprains
- Breath-O-Prene® fabric keeps wearer cool and dry
- Sleek, anatomic design for a comfortable bulk-free fit
- Simple single strap application and adjustment

Ordering Information

A60 Ankle Support					
Part Number		Size	Shoe Size		
Left	Right		EU	US Male	US Female
02TSL	02TSR	Small	< 38	< 7	< 8½
02TML	02TMR	Training (Medium)	39-42	7½ - 11½	9-13
02TLL	02TLR	Standard (Large)	> 42	> 12	> 13½



AirSport™

Indications

- Acute ankle distortion
- Ligament lesion
- Post-operative application
- Chronic ankle instability
- Prophylaxis

Features and Benefits

- Foam-filled aircell cushions and supports the ankle
- Semi-rigid encased shell offers proven Air-Stirrup® support
- Coated fabric for durability
- ATF (anterior talofibular) cross-strap for ankle stabilisation
- Integral forefoot and shin wraps for support
- Automatic heel width adjustment for easy application

Ordering Information

AirSport					
Part Number		Size	Shoe Size		
Left	Right		EU	US Male	US Female
02MXSL	02MXSR	XSmall	≤ 36	≤ 5	≤ 5
02MSL	02MSR	Small	37-40	5.5-7	5.5-8.5
02MML	02MMR	Medium	41-44	7.5-11	9-12.5
02MLL	02MLR	Large	45-47	11.5-13	13-14.5
02MXLL	02MXLR	XLarge	> 48	> 13.5	> 15



Jump Brace™

Indications

- Prophylactic protection

Features and Benefits

- Prophylactic ankle brace designed to prevent ankle trauma when worn outside a boot
- Includes lateral and medial side walls to encompass the ankle and lower extremity
- Sold in pairs

Ordering Information

Jump Brace			
Part Number	Size	Shoe Size	
		EU	US
02I	Small	< 42	< 8
02G	Medium	42-45	8-11
02H	Large	> 45	> 11



Infrapatellar Band

Indications

- Osgood Schlatter
- Patella tendonitis

Features and Benefits

- A single aircell focuses compression on the patella tendon to decrease stress at the tibial tubercle
- Available in black
- Universal fit

Ordering Information

Infrapatellar Band		
Part Number	Circumference	Color
08A-B	25-43 cm (10"-17")	Black

AirHeel™



Indications

- Chronic and acute Achilles tendonitis
- Calcaneal pain
- Plantar fasciitis

Features and Benefits

- Pulsating pneumatic compression minimises swelling and enhances circulation
- Lightweight materials and low profile design increases comfort
- Simplified design speeds application

Ordering Information

AirHeel				
Part Number	Size	Shoe Size		
		EU	US Male	US Female
09A-S	Small	≤ 39	≤ 7	≤ 8.5
09A-M	Medium	39-42	7.5-11.5	9-13
09A-L	Large	> 42	> 11.5	> 13

Dorsal Night Splint



Indications

- Plantar Fasciitis

Features and Benefits

- Optimal dorsiflexion adjustment for custom stretch
- Maximum comfort helps pain relief from Plantar Fasciitis
- Easy application with flexible hinge design and three-point pliable softgood adjustment
- Secure fit with optional assist strap to secure toes within forefoot area

Ordering Information

Dorsal Night Splint				
Part Number	Size	Shoe Size		
		EU	US Male	US Female
09DS	S / M	39-43	5-9.5	6-10.5
09DL	L / XL	43-48	10-14	11-15

AirLift™ PTTD Brace



Indications

- Phase I and initial phase II of posterior tibial tendon dysfunction
- First symptoms of flat foot

Features and Benefits

- Adjustable arch aircell for individual support and comfort
- Anatomically designed shells for secure ankle stability
- Step-in design and simple two strap application promote ease of use and compliance

Ordering Information

Airlift PTTD Brace					
Part Number		Size	Shoe Size		
Left	Right		EU	US Male	US Female
02PSL	02PSR	Small	≤ 38	≤ 7	≤ 8.5
02PML	02PMR	Medium	39-42	7.5-11	9-12.5
02PLL	02PLR	Large	> 43	> 11.5	> 13

Walkers



AirSelect™ Range

Designed for Comfort, Engineered for Healing

Our lightest Aircast walking boot ever, AirSelect brings clinically tested innovations that improve comfort, compliance, and clinical outcomes.

Integrated Inflation System for Ease of Use

NEW

Puts the patient in control for an individualized fit.

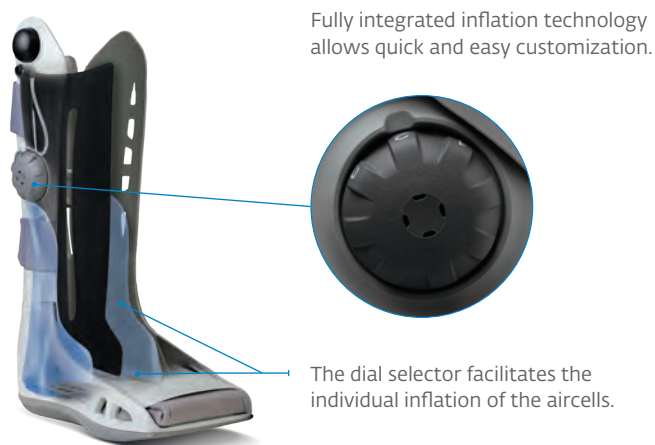

Ultra Light Technology for Compliance

NEW

The lightest full-shell walking boot available.

Semi-rigid shell integrates vents that maximize airflow and minimize mass, without compromising support.

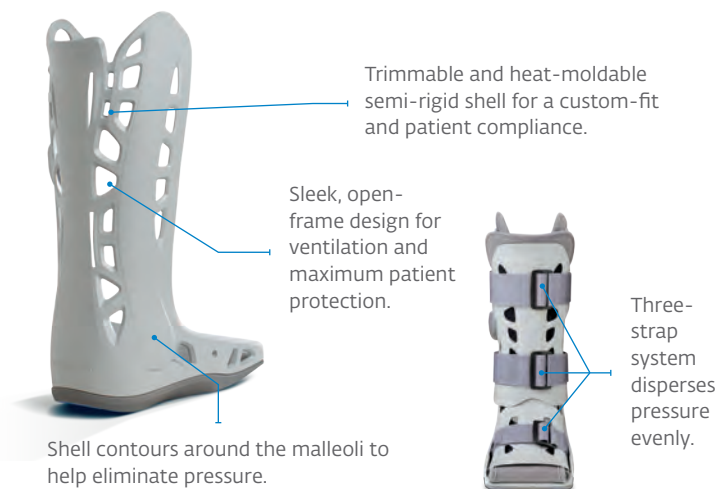

Softstrike Technology & Optimized Rocker Sole Design for Comfort

NEW

A patented grid design provides cushioning that reduces heel loading and helps prevent impact-related stresses. Shape and height of the rocker sole provide a more natural gait and less hip differential.

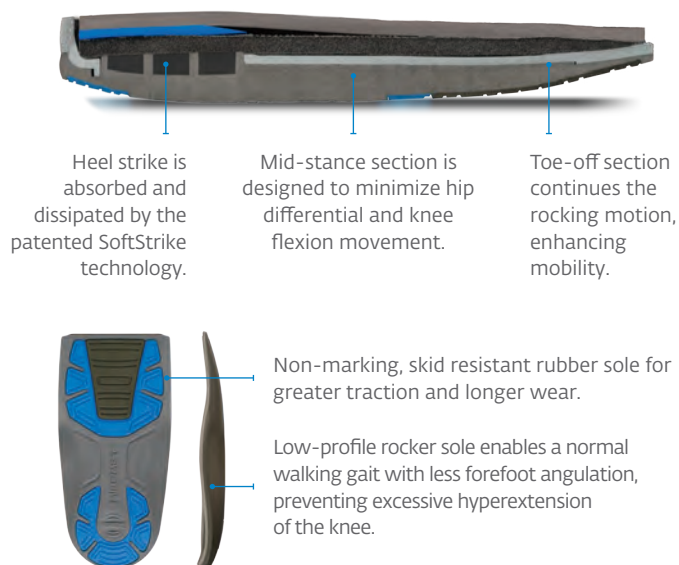

Duplex Technology for Faster Healing

Multiple aircells are layered within the semi-rigid shell to provide pulsating compression with each step. This design is clinically proven to reduce edema 3x faster, relieve pain, and speed healing.^{1,2}

During ambulation, the overlapping aircells fluctuate – resulting in a massaging motion that resorbs the edema.

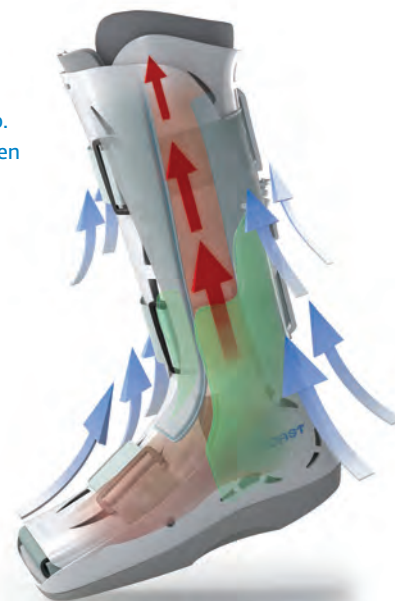

¹ Conservative Therapy for Acute Lateral Ligament Lesions – Single Chamber vs. Two-Chamber Orthosis Systems; Schmidt, Mainers, Reintges, Lipke, Benesch, Gerngross - Surgery Dept of the Federal Arm Hospital, Ulm, Germany, 1999
² A New Concept in Fracture Immobilization ; Dale PA, Bronk JT, O'Sullivan ME, et al – Clinical Orthopedics and Related Research, 1993

AirSelect™ Elite

The AirSelect Elite is the most-advanced walking boot, engineered to provide the ultimate in protection, comfort, and edema control.

Indications

- Stable fracture of foot/ankle/lower leg
- Severe ankle sprain
- Post-operative immobilization
- Reduction of edema

Features and Benefits

- Durable, semi-rigid shell helps support the limb while providing full-shell protection
- Overlapping Duplex aircells (posterior and distal) provide intermittent pneumatic compression for faster edema reduction
- Integrated Inflation System for ease of use
- Front panel is pre-inflated and combined with the overlapping aircells, provides a 'total contact' fit
- SoftStrike technology absorbs and dissipates shock, while the lightweight and lab-tested rocker sole encourage a natural gait
- Enclosed toe cover provides toe protection

Ordering Information

AirSelect™ Elite				
Part Number	Shoe Size			Size
	EU	US Male	US Female	
01EP-XS	≤ 35.5	< 4	< 5	XSmall
01EP-S	35.5-39.5	4-7	5-8	Small
01EP-M	39.5-43	7-10	8-11	Medium
01EP-L	43-47	10-13	11-15	Large
01EP-XL	47+	> 13	> 15	XLarge

Accessories		
Part Number	Description	Size
01E102X	Liner & Insole Replacement Kit "Elite"	XS, S, M, L, XL
01E101X	Liner & Insole Replacement Kit "Standard"	XS, S, M, L, XL
01E100X	Liner & Insole Replacement Kit "Short"	XS, S, M, L, XL
01E104X	Strap Replacement Kit "Elite" & "Standard"	XS/S, M/L, XL
01E103X	Strap Replacement Kit "Short"	XS/S, M/L, XL
01E1050	Kit Extension Straps Replacement	U



AirSelect™ Standard

The Standard walking boot offers a moderate level of support and Aircast's quality, effectiveness and comfort in an economical model.



Indications

- Stable fracture of foot/ankle/lower leg
- Severe ankle sprain
- Post-operative immobilization

Features and Benefits

- Durable, semi-rigid shell that supports the limb while providing protection
- Housed within the shell are two adjustable distal aircells that provide compression and support the malleoli
- Integrated Inflation System for ease of use
- SoftStrike technology absorbs and dissipates shock, while the lightweight and lab-tested rocker sole encourage a natural gait

Ordering Information

AirSelect™ Standard				
Part Number	Shoe Size			Size
	EU	US Male	US Female	
01EF-XS	≤ 35.5	≤ 4	≤ 5	XSmall
01EF-S	35.5-39.5	4-7	5-8	Small
01EF-M	39.5-43	7-10	8-11	Medium
01EF-L	43-47	10-13	11-15	Large
01EF-XL	47+	13+	15+	XLarge

AirSelect™ Short

The Short walking boot offers a solution to a number of indications related to the forefoot, mid-foot and hind foot injuries, as well as some ankle injuries.



Indications

- Metatarsal fracture
- Stress and stable fracture of the foot
- Bunionectomy, hallux valgus
- Soft tissue injury
- Severe ankle sprain

Features and Benefits

- The Short has a durable, semi-rigid shell that helps support the limb while providing protection
- The pre-inflated front panel and two customizable distal aircells provide compression and support
- Integrated Inflation System for ease of use
- SoftStrike technology absorbs and dissipates shock, while the lightweight and lab-tested rocker sole encourage a natural gait

Ordering Information

AirSelect™ Short				
Part Number	Shoe Size			Size
	EU	US Male	US Female	
01ES-XS	≤ 35.5	≤ 4	≤ 5	XSmall
01ES-S	35.5-39.5	4-7	5-8	Small
01ES-M	39.5-43	7-10	8-11	Medium
01ES-L	43-47	10-13	11-15	Large
01ES-XL	47+	13+	15+	XLarge

Accessories



Weather Cover

- Designed to be worn with the Aircast Walker to protect against bad weather
- Made of durable water repellent material
- Available in 2 heights, 3 sizes

Ordering Information

Weather Cover		
Tall	Short	Size
01WXT-S	01WXS-S	XSmall/Small
01WXT-L	01WXS-L	Medium/Large
01WXT-XL	01WXS-XL	XLarge



Hygiene Cover

- Easy to apply Hygienic cover, intended for indoor use
- Prevents surfaces from being soiled by the soles of the Walker (carpets, furniture, beds ...)
- Not suitable for outdoor usage
- Made of breathable nylon material with antislip sole

Ordering Information

Hygiene Cover	
Part Number	Size
0130A-PED/S	XSmall/Small
0130A-M/L	Medium/Large
0130A-XL	XLarge



Semi-Rigid Toe Cover

- Made of a thin polycarbonate flexible plastic material and covered with a soft, nylon foam
- Provides ideal coverage and additional protection for patients
- The Aircast Toe Cover comes in 2 sizes and will fit all Aircast style walking boots

Ordering Information

Semi-rigid Toe Cover	
Part Number	Size
01T-S	XSmall/Small
01T-L	Medium/Large/XLarge



Brace-Lok™

- Compliance monitoring system

Ordering Information

Brace-Lok™		
Part Number	Quantity	Size
01P414	10 PK.	Univ.



Heel Wedges

- The heel wedges can be placed on top of each other to achieve the desired heel rise
- Indicated for post-Achilles tendon surgery
- Heel rise angle :
 - 3 heels: 22 degrees
 - 2 heels: 16 degrees
 - 1 heel: 10 degrees

Ordering Information

Heel Wedges		
Left	Right	Size
01K-L	01K-R	Standard (S,M,L)
01K-XLL	01K-XLR	XLarge

XP Diabetic Walker™

**Indications**

- Neuropathic ulcers
- Stable foot and/or ankle fracture
- Hind foot and heel foot protection
- Soft tissue injury

Features and Benefits

- Incorporates a high rocker sole for maximum offload of the diabetic foot
- An innovative dual density insole helps eliminate pressure points
- A combination of semi-rigid full aircell-lined shell and insole help regulate shear stress
- Regulated aircell inflation possible with specialised hand bulb
- Comes with two insoles, three stockings and one hand bulb with pressure gauge

Ordering Information

XP Diabetic Walker				
Part Number	Size	Shoe Size		
		EU	US Male	US Female
01PD-S	Small	35-38	4-7	5-8
01PD-M	Medium	39-42	7-10	8-11
01PD-L	Large	43-45	10-13	11-15

Accessories	
Part Number	Description
01PG	Replacement Pump with Pressure Gauge
01R-X	Diabetic Replacement Kit (includes 1 sock and 1 insole) S, M, L, XL
01PI-X	IMPAX Grid Insole Replacement Kit (includes 1 sock and 1 insole) S, M, L, XL
4003	Replacement Diabetic Sock

IMPAX Grid Insole



Diabetic Sock



Diabetic Pump



Upper Extremity



A2™ Wrist Brace



Indications

- Wrist sprain
- Carpal tunnel syndrome
- Wrist support after cast removal
- Tendonitis of the wrist
- Thumb injuries (version with thumb)

Features and Benefits

- Easy-to apply
- Available with or without thumb support
- Can be worn for most daily activities
- Breathable Lycra®-lined support with rigid stay

Ordering Information

A2 Wrist Brace			
Part Number		Size	Wrist Circumference
Left	Right		
05WSL	05WSR	Small	12.7-16.5 cm (5"-6.5")
05WML	05WMR	Medium	15.9-19.7 cm (6"-7.75")
05WLL	05WLR	Large	19-22.9 cm (7.5"-9")
05WTSL	05WTSR	Small w/Thumb Support	12.7-16.5 cm (5"-6.5")
05WTML	05WTMR	Medium w/Thumb Support	15.9-19.7 cm (6"-7.75")
05WTLL	05WTLR	Large w/Thumb Support	19-22.9 cm (7.5"-9")

StabilAir™ Wrist Brace



Indications

- Post-operative after wrist fractures
- Other wrist injuries requiring maximum stabilisation or immobilisation

Features and Benefits

- Water-resistant brace with easy to apply plastic shell design
- Adjustable aircells allow perfect customised fit
- Hand pump allows aircells to be adjusted to provide a custom fit

Ordering Information

StabilAir Wrist Brace			
Part Number		Size	Wrist Circumference
Left	Right		
05FSL	05FSR	Small	12.7-16.5 cm (5"-6")
05FML	05FMR	Medium	15.9-19.7 cm (6"-7.75")



Quick-Fit Shoulder Immobiliser

Indications

- Shoulder and stable arm fractures (clavicle, proximal or mid-humerus fractures)
- Acromioclavicular joint injuries in acceptable position
- Shoulder dislocations that have been reduced
- Rotator cuff injuries
- Soft tissue injuries
- Support after surgical repair

Features and Benefits

- Constructed of breathable mesh for a cool, comfortable fit
- Release clip design on the waist allows for easy removal without changing the fit adjustment
- Universal fit by folding the sling onto itself, to adjust to the arm length of the patient
- Fits Left or Right, Small or Large
- 15° abduction pillow for proper arm placement in internal rotation
- Thumb loop to hold the hand in place
- Sling portion features a top strap that can be released for easy access to the arm for controlled ROM exercises
- A removable exercise ball is included to promote circulation-enhancing exercises
- The shoulder strap is simply inserted through two "O" rings, and allows for sizing by adjusting the strap

Ordering Information

Quick-Fit Shoulder Immobiliser			
Part Number	Min Length*	Max Length*	Depth
06AB	26.5 cm / 10.5"	43 cm / 17"	18 cm / 7"
06A (Sling Only)	26.5 cm / 10.5"	43 cm / 17"	18 cm / 7"



Arm Immobiliser

Indications

- Rotator cuff repair
- Glenohumeral (sub)luxation
- Soft tissue repair

Features and Benefits

- Arm sling with abduction pillow and underarm strap to avoid posterior arm mobility
- Supportive shoulder strap to reduce stress on the neck
- Fits left and right

Ordering Information

Arm Immobiliser		
Part Number	Size	Arm Length
06GM	Medium	< 25 cm (< 10")
06GMA	Medium w/Pillow	< 25 cm (< 10")
06GL	Large	> 25 cm (> 10")
06GLA	Large w/Pillow	> 25 cm (> 10")

Mayo Clinic Elbow Brace

Indications

- Elbow contractures
- Elbow reconstruction
- Acute fracture dislocation
- Biceps/triceps tendon rupture
- Ulnar nerve transposition
- Total elbow arthroplasty

Features and Benefits

- Lock/unlock mechanism to enable rapid switch between immobilisation, static stretch and free ROM
- Calibrated control knob is easy to read and assist in monitoring progress
- Universal size
- Repositionable hinge stops control range-of-motion
- ARC™ Forearm Rotational Brace may be used for additional pronation and supination control

Ordering Information

Mayo Clinic Elbow Brace		
Part Number		Size
Left	Right	
05E-L	05E-R	Universal

Accessories		
Part Number	Description	Size
05EW	ARC Forearm Rotational Brace	Universal



Pneumatic Armband

Indications

- Tennis elbow

Features and Benefits

- Armband with pre-inflated aircell for concentrated compression on extensor muscle
- Simple, effective design for easy application
- One size fits all

Ordering Information

Pneumatic Armband		
Part Number	Arm Circumference	Color
05A	20-35.5 cm (8"-14")	Beige
05A-B	20-35.5 cm (8"-14")	Black



Cold Therapy





Cryo/Cuff™ IC Cooler

Indications

- Provides intermittent compression to minimize hemarthrosis, swelling and pain

Features and Benefits

- Integrated pneumatic pump within the cooler lid provides a 45 second on/30 second off cycle of automated compression and cold therapy
- Its ease of operation makes it ideal for post-operative recovery, trauma, athletic training rooms and home use
- The IC Cooler is compatible with all Cryo/Cuff wraps

Ordering Information

Cryo/Cuff IC Cooler	
Part Number	Description
52A	Cryo/Cuff IC Cooler

Accessories	
Part Number	Description
25-0238	Cryo/Cuff IC Lid
25-4882	Cryo/Cuff IC Cooler power supply (US)
25-2740	Universal power supply (all markets excl. US)



Cryo/Cuff™ Cooler

Indications

- General haemarthrosis
- Swelling and pain post surgery and post injury

Features and Benefits

- Cryo/Cuff utilizes gravity to deliver chilled water to anatomically specific cuff
- Cooler holds water and ice needed for 6 to 8 hours of cryotherapy
- Compatible with all Cryo/Cuff pads
- Includes tube assembly and insulation disk
- Labelled with simple-to follow directions for use

Ordering Information

Cryo/Cuff Cooler	
Part Number	Description
2125	Cryo/Cuff Cooler

AutoChill® System

Indications

- Designed for use with the Aircast Cryo/Cuff Cooler
- During operation, the electronic pump automatically cycles and compresses the air in the cooler to force chilled water into the cuff

Features and Benefits

- Automatically cycles the water between the cooler and cuff
- Repetitive cycling maintains continuous cold and applies soothing pulsating pressure
- Eliminates the need for manual recycling

Ordering Information

AutoChill System	
Part Number	Description
20B	AutoChill System (120V AC) - US Power Supply
20BG-E	AutoChill System (230V AC) - European Power Supply
2007	Replacement tube 50 cm
2007XL	Replacement tube 1.50 m



Cryo/Cuff™ Wraps & Cuffs

Indications

- The anatomically designed cuffs provide the therapeutic benefits of controlled cold compression to minimise haemarthrosis and swelling and reduce pain

Features and Benefits

- Cuffs are anatomically designed to cover all major joints of the body
- Cuffs provide maximum coverage for optimum cryotherapy treatment
- Soothing cold covers the affected area reducing swelling and providing pain relief
- Cuffs are simple to apply and remove and may be detached from the cooler at any time for mobility without interruption of treatment



Ordering Information

Cryo/Cuff Wraps & Cuffs					
Part Number		Description	Size		
Cuff	Cuff and Cooler				
10C01	10C	Foot Cryo/Cuff	M	Foot Circumference	23-33 cm (9"-13")
10B01	10B	Foot Cryo/Cuff	L		25-43 cm (10"-17")
10A01	10A	Ankle Cryo/Cuff	U	Universal	
11C01	11C	Knee Cryo/Cuff	S	Circumference 15 cm (6") above patella	25-50 cm (10"-19")
11A01	11A	Knee Cryo/Cuff	M		45-60 cm (18"-23")
11B01	11B	Knee Cryo/Cuff	L		50-80 cm (20"-31")
11ASC	-	Knee Cryo/Cuff SC	U	Universal	
13C01	-	Calf Cryo/Cuff	U	Calf Circumference	36-51 cm (14"-20")
13A01	-	Thigh Cryo/Cuff	L	Thigh Circumference	43-58 cm (17"-23")
13B01	-	Thigh Cryo/Cuff	XL		51-69 cm (20"-27")

Cryo/Cuff Wraps & Cuffs					
Part Number		Description	Size		
Cuff	Cuff and Cooler				
16A01	16A	Hand/Wrist Cryo/Cuff	Universal		
15A01	15A	Elbow Cryo/Cuff	Universal		
12A01	12A	Shoulder Cryo/Cuff	U	Torso Circumference	81-122 cm (32"-48")
12B01	-	Small Shoulder Cryo/Cuff	S		< 86 cm (< 34")
12AXL01	12AXL	Shoulder Cryo/Cuff with Extra Long Strap	XL		107-137 cm (42"-54")
1220XL	-	Shoulder Strap	XL		
14A01	14A	Back/Hip/Rib Cryo/Cuff	Universal		
11P01	-	Pediatric Knee/Elbow Cryo/Cuff	Pediatric		
10P01	10P	Pediatric Ankle Cryo/Cuff	Pediatric		

DJO GLOBAL, EXPORT CENTRES

ASIA-PACIFIC:

DJO Asia-Pacific Limited
Unit 1905, 19/F, Tower II
Grand Central Plaza
138 Shatin Rural Committee Road
Shatin
HONG KONG
T: +852 3105 2237
F: +852 3105 1444
E: info.asia@DJOglobal.com

EUROPE, MIDDLE EAST & AFRICA:

DJO Benelux
Welvaartstraat 8
2200 Herentals
BELGIUM
T: +32 (0) 14248350
F: +32 (0) 14248358
E: info.emea@DJOglobal.com

LATIN AMERICA:

DJO Global, Inc
1430 Decision Street
Vista
CA 92081-8553
U.S.A.
T: 1 800 336 6569
F: 1 800 936 6569
E: info.latam@DJOglobal.com

DJO GLOBAL

AUSTRALIA:

T: +1300 66 77 30
F: +1300 66 77 40
E: service@djortho.com.au

BENELUX:

T: Belgium 0800 18 246
T: Netherlands 0800 0229442
T: Luxemburg 8002 27 42
E: benelux.orders@DJOglobal.com

CANADA:

T: +1 866 866 5031
F: +1 866 866 5032
E: canada.orders@DJOglobal.com

CHINA:

T: (8621) 6031 9989
F: (8621) 6031 9709
E: information_china@DJOglobal.com

DENMARK, FINLAND, NORWAY & SWEDEN:

T: Sweden 040 39 40 00
T: Norway 8006 1052
T: Finland 0800 114 582
T: Denmark +46 40 39 40 00
E: info.nordic@DJOglobal.com

FRANCE:

T: +33 (0)5 59 52 86 90
F: +33 (0)5 59 52 86 91
E: sce.cial@DJOglobal.com

GERMANY:

T: +49 761 4566 01
F: +49 761 456655 01
E: infoservice@DJOglobal.com

ITALY:

T: +39 02 484 63386
F: +39 02 484 09217
E: it.info@DJOglobal.com

INDIA:

T: +91 44 66915127
E: customercare.india@DJOglobal.com

SOUTH AFRICA:

T: +27 (0) 87 3102480
F: +27 (0) 86 6098891
E: info.southafrica@DJOglobal.com

SPAIN:

T: +34 934 803 202
F: +34 934 733 667
E: ventas@DJOglobal.com

SWITZERLAND:

T: +41 (0) 21 695 2360
F: +41 (0) 21 695 2361
E: info@compex.ch

UK & IRELAND:

T: +44 (0)1483 459 659
F: +44 (0)1483 459 470
E: ukorders@DJOglobal.com

UNITED STATES:

T: +1 800 336 6569
F: +1 800 936 6569
E: customercare@DJOglobal.com



Together in Motion™